

Plotted By: Richter, Nicole - Street - Autozone - Layout - L-100 - TREE DISPOSITION PLAN - January 29, 2020 - 03:08:15pm - K:\WPB\JRC\042348007 - Autozone - Autozone\CAD\Autozone\Autozone - L-100 - TREE DISPOSITION PLAN.dwg
This document, together with the concepts and designs presented herein, is an instrument of service, is intended only for the specific purpose and client for which it was prepared. Reuse of any material herein without written authorization and approval by Kimley-Horn and Associates, Inc. shall be without liability to Kimley-Horn and Associates, Inc.

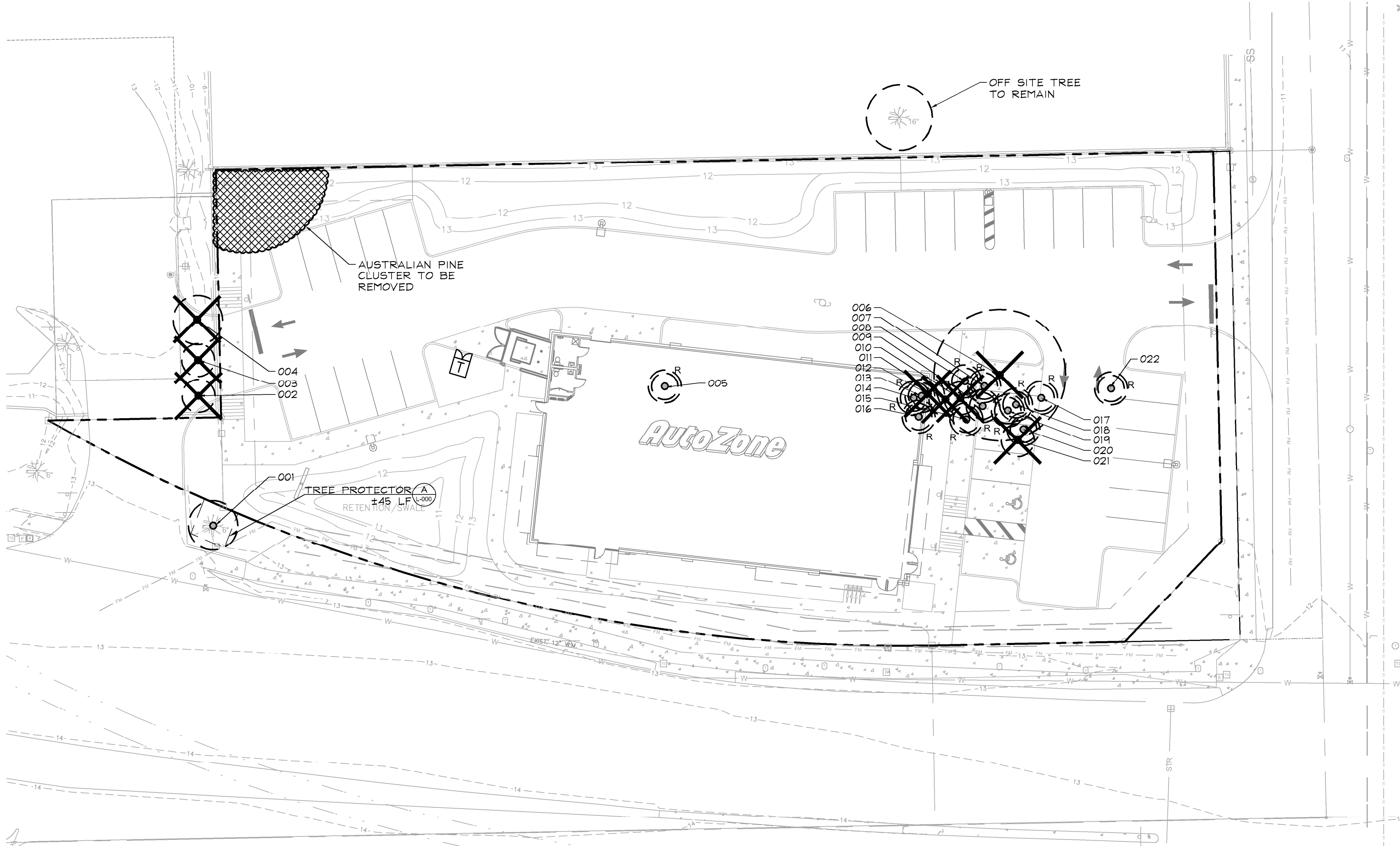

TREE DISPOSITION LEGEND	
	EXISTING TREE TO REMAIN
	EXISTING TREE TO BE REMOVED
	EXISTING TREE TO BE RELOCATED

- PALM RELOCATION NOTES**
1. PALMS SHALL BE RELOCATED ONCE FROM THEIR PRESENT LOCATION TO A DESIGNATED LOCATION ON THE LANDSCAPE PLAN. RELOCATION ACTIVITIES WILL INCLUDE PLANTING ON SLOPES AND/OR LEVEL GRADE.
 2. AN ISA - CERTIFIED ARBORIST OR A CERTIFIED LANDSCAPE CONTRACTOR CERTIFIED BY THE FLORIDA NURSERYMEN AND GROWERS ASSOCIATION SHALL PERFORM AND MONITOR ALL PALM ROOT PRUNING AND RELOCATION ACTIVITIES.
 3. LANDSCAPE SPECIFICATIONS PROVIDED IN THIS CONSTRUCTION SET SHALL APPLY TO ALL RELOCATED PALMS.
 4. CONTRACTOR SHALL STAKE AND GUY ALL PALMS AT THE TIME OF TRANSPLANT AS PER DETAILS PROVIDED IN THIS CONSTRUCTION SET. CONTRACTOR SHALL BE RESPONSIBLE FOR THE MAINTENANCE AND/OR REPAIR OF STAKING AND GUYING DURING THE WARRANTY PERIOD. ALL PALMS SHALL BE BRACED AT LEAST ONE (1) YEAR OR AS DIRECTED BY THE OWNER'S REPRESENTATIVE.
 5. SOIL BACKFILL FOR THE INSTALLATION OF PALMS SHALL BE UNIFORM MIX OF 25% WELL-ROTTED COMPOST AND 75% CLEAN, WEED-FREE LOOSENED NATIVE SOIL BACKFILL.
 6. CONTRACTOR SHALL SUBMIT MANUFACTURERS CERTIFIED ANALYSIS FOR SOIL AMENDMENTS TO THE OWNER'S REPRESENTATIVE.
 7. CONTRACTOR SHALL PAY TO HAVE THE BACKFILL LAB TESTED IF REQUESTED BY THE OWNER'S REPRESENTATIVE.
 8. REFER TO STAKING DETAIL B SHEET L-210.

AUTOZONE 6395 - TREE DISPOSITION TABLE										
Tree #	Botanical Name	Common Name	DBH (IN)	Height (FT)	Spread (FT)	Canopy (SF)	Condition	Disposition	Assessed Value	Appraisal Method
1	<i>Quercus virginiana</i>	Live Oak	8	20	15	177	Good	Remain/Protect	\$1,220	TFM
2	<i>Lagerstroemia indica</i>	Crepe Myrtle	6	18	10	79	Good	Remove/Mitigate	\$440	TFM
3	<i>Lagerstroemia indica</i>	Crepe Myrtle	6	18	10	79	Good	Remove/Mitigate	\$440	TFM
4	<i>Quercus virginiana</i>	Live Oak	11	20	15	177	Good	Remove/Mitigate	\$2,090	TFM
5	<i>Sabal palmetto</i>	Sabal Palm		20	15	177	Good	Relocate	\$230	RCM
6	<i>Ficus aurea</i>	Strangler Fig	48	35	40	1256	Poor	Remove/Mitigate	\$13,151	TFM
7	<i>Sabal palmetto</i>	Sabal Palm		30	15	177	Fair	Relocate	\$200	RCM
8	<i>Sabal palmetto</i>	Sabal Palm		20	10	79	Fair	Relocate	\$200	RCM
9	<i>Sabal palmetto</i>	Sabal Palm		30	15	177	Fair	Relocate	\$240	RCM
10	<i>Sabal palmetto</i>	Sabal Palm		30	15	177	Poor	Remove/Mitigate	\$200	RCM
11	<i>Sabal palmetto</i>	Sabal Palm		15	10	79	Poor	Remove/Mitigate	\$200	RCM
12	<i>Sabal palmetto</i>	Sabal Palm		15	10	79	Poor	Remove/Mitigate	\$200	RCM
13	<i>Sabal palmetto</i>	Sabal Palm		15	10	79	Good	Relocate	\$250	RCM
14	<i>Sabal palmetto</i>	Sabal Palm		15	10	79	Good	Relocate	\$250	RCM
15	<i>Sabal palmetto</i>	Sabal Palm		30	15	177	Fair	Relocate	\$220	RCM
16	<i>Sabal palmetto</i>	Sabal Palm		20	15	177	Good	Relocate	\$250	RCM
17	<i>Sabal palmetto</i>	Sabal Palm		20	15	177	Fair	Relocate	\$200	RCM
18	<i>Sabal palmetto</i>	Sabal Palm		20	15	177	Poor	Relocate	\$250	RCM
19	<i>Sabal palmetto</i>	Sabal Palm		30	15	177	Fair	Relocate	\$220	RCM
20	<i>Sabal palmetto</i>	Sabal Palm		20	15	177	Good	Relocate	\$250	RCM
21	<i>Sabal palmetto</i>	Sabal Palm		12	10	79	Poor	Remove/Mitigate	\$200	RCM
22	<i>Sabal palmetto</i>	Sabal Palm		20	15	177	Fair	Relocate	\$230	RCM

TREE DISPOSITION SUMMARY	
TREES TO BE REMOVED	5
PALMS TO BE REMOVED	4
PALMS TO BE RELOCATED	13
DOLLAR VALUE TO BE REMOVED	\$16,921

NOTE: TREE REPLACEMENT COMPLIANCE PER SECTION 155.5204.E.1.b.i SHOWN ON SHEETS L-200 & L-201

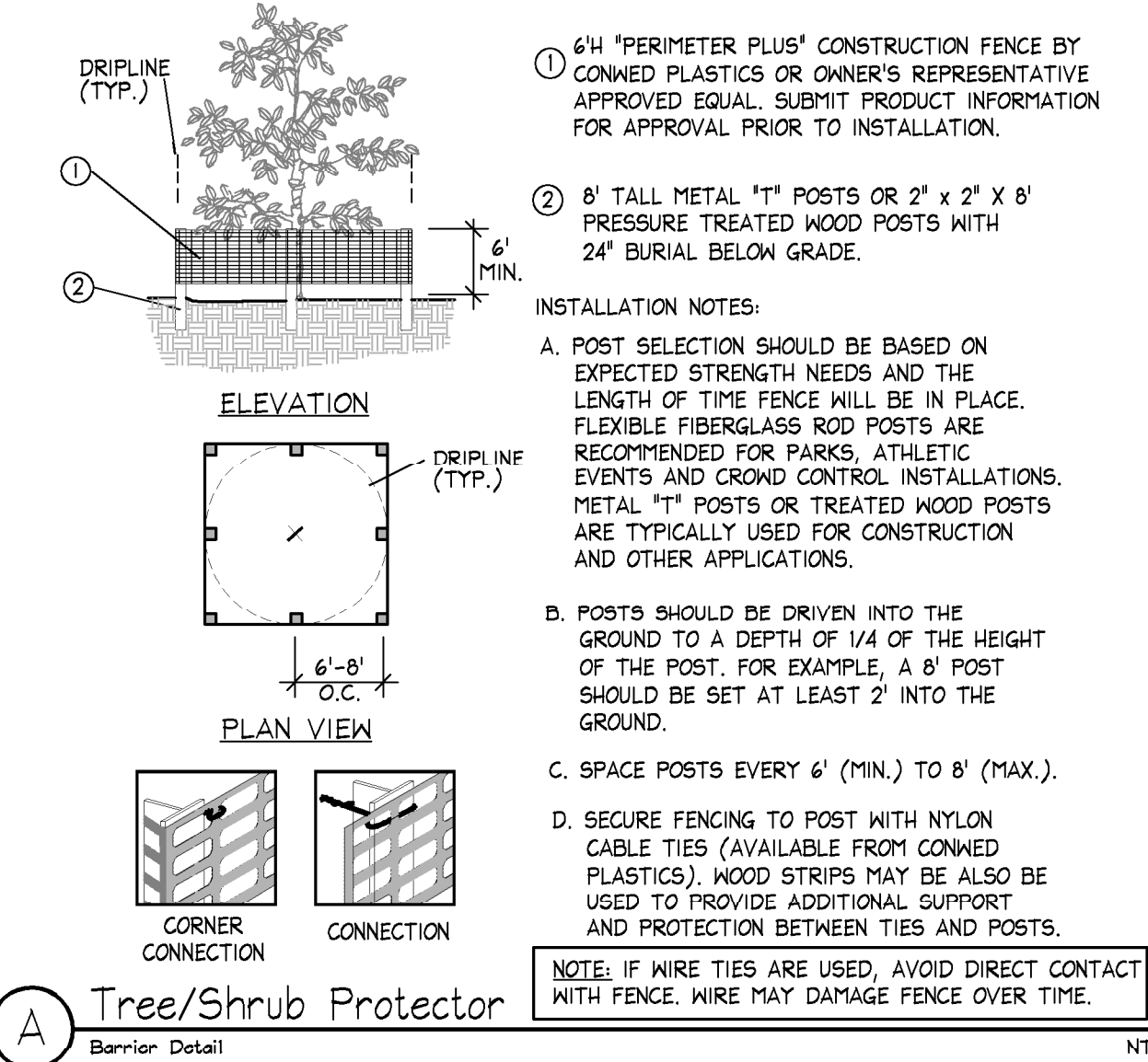

ASSESSED VALUES PER TREE APPRAISALS BY KIMLEY-HORN AND ASSOCIATES DATED 4/28/2017
RCM: REPLACEMENT COST METHOD
TFM: TRUNK FORMULA METHOD

KHA PROJECT 0-2348007		DATE JAN. 29, 2020	SCALE AS SHOWN	DESIGNED BY SF	DRAWN BY SF	CHECKED BY JH	DATE 01/29/20
KIMLEY-HORN		© 2017 KIMLEY-HORN AND ASSOCIATES, INC. 1920 WEKIVA WAY SUITE 200, WEST PALM BEACH, FL 33411 PHONE: 561-845-6665 FAX: 561-863-8175 WWW.KIMLEY-HORN.COM CA 00000696		Tricia C. Richter 20200501 17-38-533 05'00"		FLORIDA LICENSE NUMBER LA#1500244	
TREE DISPOSITION PLAN		AUTOZONE 6365 PREPARED FOR AUTOZONE		FLORIDA POMPANO BEACH		SHEET NUMBER -100	

AAC
PZ20-12000007
2/2/21

AAC
PZ20-12000007
03/03/2020